

ERGOPLUS 25



CE EN60974-7

CODE	↔		
------	---	--	--

MA7243	3 m	10'	
MA7244	4 m	12'	
MA7245	5 m	16.4'	

MA7290T	3 m	10'	
MA7291T	4 m	12'	
MA7292T	5 m	16.4'	

MA7290M	3 m	10'	
MA7291M	4 m	12'	
MA7292M	5 m	16.4'	

MA7290L	3 m	10'	
MA7291L	4 m	12'	
MA7292L	5 m	16.4'	

CODE	↔		
------	---	--	--

MA7290	3 m	10'	
MA7291	4 m	12'	
MA7292	5 m	16.4'	

+	
AR0170	Tweco® 1/4 KIT
AR0172	Lincoln® KIT
AR0173	Miller® KIT
KIT to be assembled by a qualified technician	

TECHNICAL DATA		
----------------	--	--

	1,2 kg	2.76 lb
V PEAK	113	
	0,8 ÷ 1,2 mm	.030" ÷ .045"
X 60%	230A CO2 - 220A Mix	

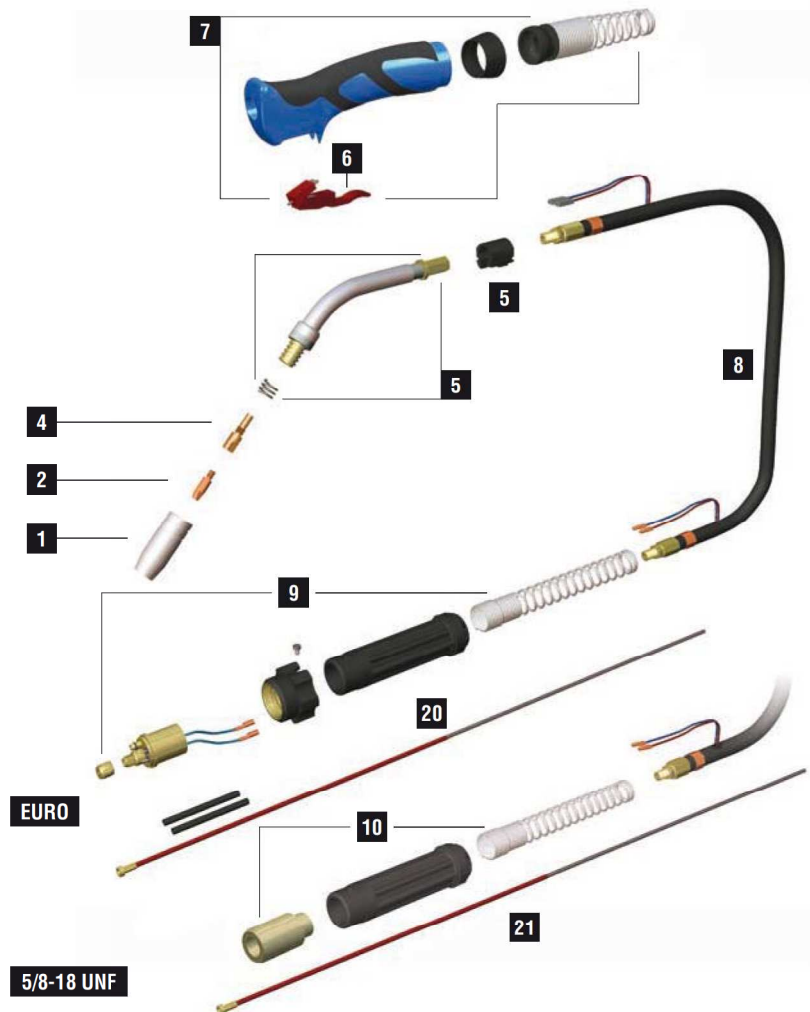

	CODE			Ø			REF		
1	MC0022			11,5 mm			145.0124	10	
1	MC0023			15 mm			145.0076	10	
1	MC0024			18 mm			145.0042	10	
1	MC0025			20 mm			145.0169	10	
1	MC0265			11 mm			-	10	
1	MC0267			14 mm				10	
2	MD0009-06		M6 - Cu	0,6 mm	.023"	28 mm	140.0005	20	
2	MD0009-08		M6 - Cu	0,8 mm	.030"	28 mm	140.0051	20	
2	MD0009-09		M6 - Cu	0,9 mm	.035"	28 mm	140.0169	20	
2	MD0009-10		M6 - Cu	1,0 mm	.040"	28 mm	140.0242	20	
2	MD0009-12		M6 - Cu	1,2 mm	.045"	28 mm	140.0379	20	
2	MD0009-14		M6 - Cu	1,4 mm	.052"	28 mm	-	20	
2	MD0009-16		M6 - Cu	1,6 mm	1/16"	28 mm	140.0555	20	
4	ME0016		M6 - opper			35 mm	142.0001	10	
4	ME0060		M6 - copper			37 mm	-	10	
4	ME0216		M6 - brass			35 mm	-	10	
20	GM0510		red steel liner	1,0 ÷ 1,2 mm	.040" ÷ .045"	3 m	10'	124.0026	1
20	GM0511		red steel liner	1,0 ÷ 1,2 mm	.040" ÷ .045"	4 m	12'	124.0031	1
20	GM0512		red steel liner	1,0 ÷ 1,2 mm	.040" ÷ .045"	5 m	16.4'	124.0035	1
21	GM0012		red steel liner	1,0 ÷ 1,2 mm	.040" ÷ .045"	5 m	16.4'	42-4045-15	1

	CODE		
5	BW0080		10
5	EA0304		
5	FB0112		10
5	MF0033		1
6	BX0024		
7	MT0237		1
8	MH0119		3 m - 10' - 25 mm ²
8	MH0124		4 m - 12' - 25 mm ²

	CODE			
8	MH0125		5 m - 16.4' - 25 mm ²	
9	AR0070		EURO connection	1
9	BW0020		Euro nut metal	
9	FA0026		liner nut M10X1	
9	MT0229		Back box kit euro	1
10	FB0399			
10	MT0228		Back box kit 5/8-18 UNF	1

STANDARD

FOR ALL CONSUMABLES SEE PAGE 294